



1 Neweena Place Avalon Beach NSW

4 🛏 2 🚿 2 🚗

Tucked between Whale Beach and Careel Bay, just up from the shops and playing fields, Neweena Place is one of those charming old-school cul-de-sacs; family-friendly with just a handful of houses. Number 1 enjoys prime position with a commanding wide frontage and wrap around bushland views, ranging from Bangalley Headland on the ocean side through to Ku-ring-gai National Park on the Pittwater side. Currently designed for multi-generational living, spread over two equally inviting levels, the vibe is warm, welcoming and relaxed. Complete with easy parking directly to the door, this spacious 1980's solid brick, 2 storey home + cabin represents exceptional bang for your buck!

Upper Level :

[For full version visit the website](https://www.blakeproperty.com.au)

Type : House
Price : Auction
View : <https://www.blakeproperty.com.au/sale/nsw/north-ern-beaches/avalon-beach/residential/house/8206336>



Andrew Blake
02 9973 4444



Zac Pearson
02 9973 4444

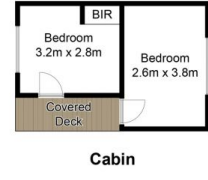

Internal Area: 184m²
Cabin Area: 21m²
Deck/Undercover Area: 48m²

Whilst BWRM & Blake Property has made every attempt to ensure the accuracy of the floor plan and site plan contained here, measurements are approximate and no responsibility is taken for any error, omissions or mis-statements. This plan is for illustrative purposes only. Boundaries are approximate only and should not be relied upon.

1 Neweena Place, Avalon Beach

