



62 Riviera Avenue Avalon Beach NSW

3 1 2

Say goodbye to the 1950's picket fence and hello to the 60's 'wild child'. When it was first designed by Architect, Nino Sydney, the famous 'Beachcomber' home was indicative of a brave, forward thinking era. He designed a home to represent affordable, cutting edge design with a bold nod to modernism. The current family proudly built their much loved 'Beachcomber' in 1966 and the highly functional, simple design provided them with a long life of enjoyment (but now it's time for someone else to give it some TLC, to bring it back to life).

Price : \$ 1,310,000

View : <https://www.blakeproperty.com.au/sale/nsw/north-ern-beaches/avalon-beach/residential/house/5746046>

- ? Sought after 'diamond in the rough' price bracket
- ? Serene Pittwater & ocean views
- ? Blissful all day east/west sunshine
- ? Easy care gardens with impressive tropical planting
- ? Quiet, tranquil street fringed with bushland reserves and nature



Andrew Blake
02 9973 4444

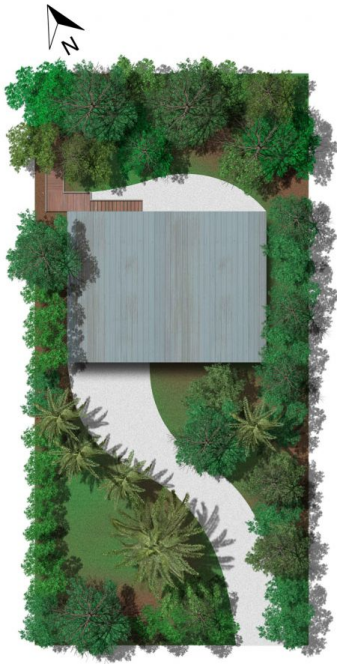

Site Plan



Upper Floor

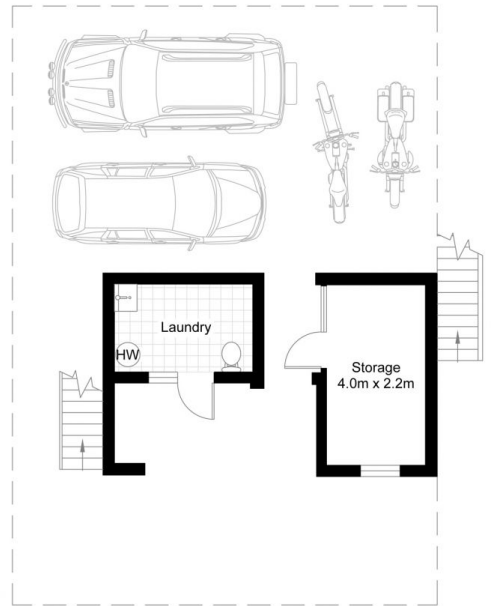

Lower Floor

Approx. Internal Area: 107m² incl. laundry & storage

We have made every attempt to ensure the accuracy of the floor plan contained here, measurements are approximate and no responsibility is taken for any error, omission, or mis-statement. This plan is for illustrative purposes only. Boundaries are approximate only and should not be relied upon.



62 Riviera Avenue, Avalon Beach

