

19 Loombah Street Newport NSW

4 🏠 3 🚗 4 🚗

tucked away along a private road, this wonderfully light filled and immaculate haven enjoys a glorious outlook over Pittwater providing a tranquil, private getaway in a bushland setting. warm timber finishes create an inviting, casual elegance, and a choice of outdoor living areas ensure effortless entertaining for any occasion.

Land Size : 885 sqm
View : https://www.blakeproperty.com.au/sale/nsw/northern-beaches/newport/residential/house/5745644

the open plan design is superbly functional, featuring plentiful living and dining space featuring a beautiful fireplace for those cool winter nights. glass doors and windows spill out on to a massive wraparound timber alfresco deck with an expansive undercover dining and barbecue area. perfectly laid out for the home chef who loves to entertain, the open kitchen is complete with a CaesarStone island bar, a stainless steel gas cooktop and direct access to the rear deck.



Andrew Blake
02 9973 4444

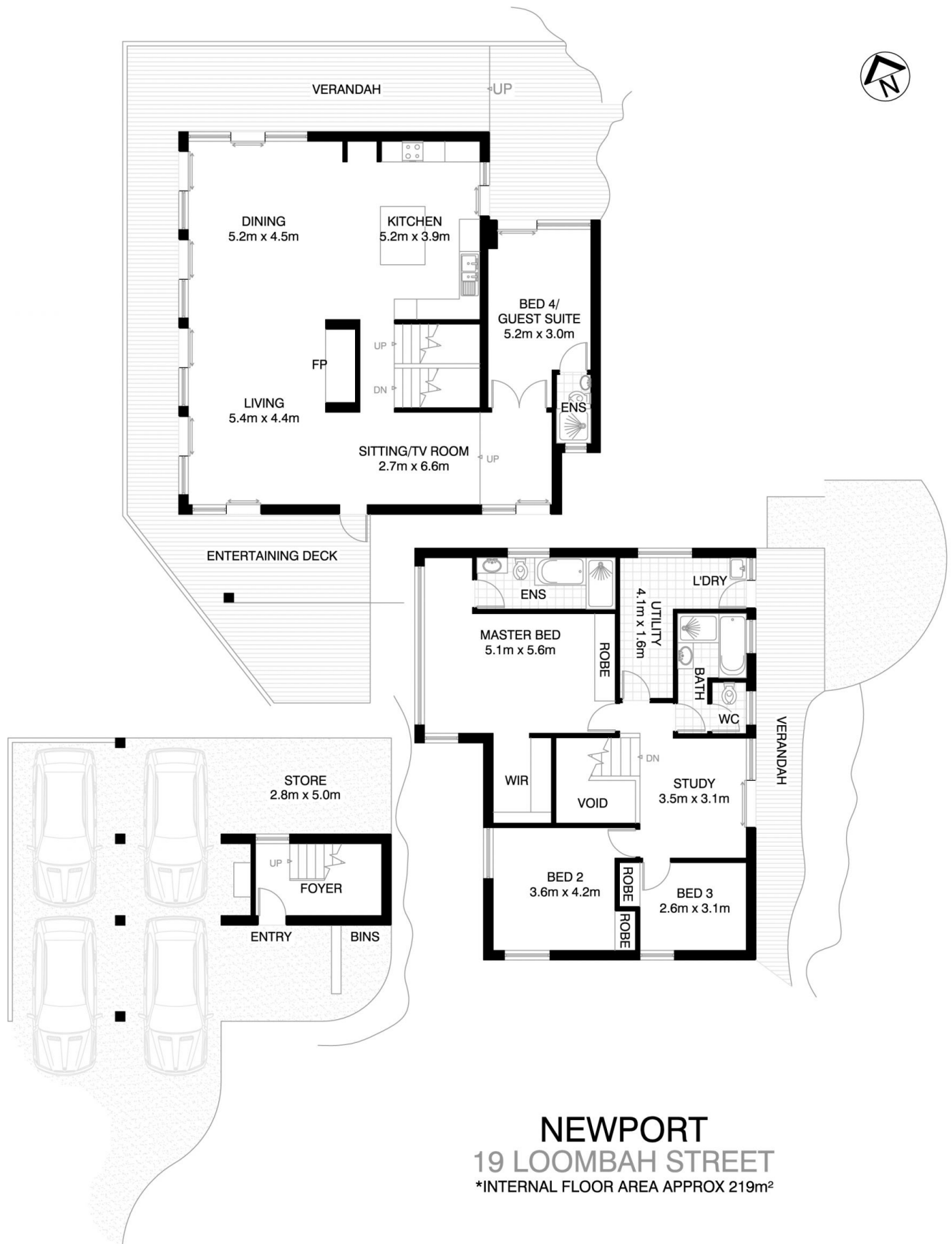

NEWPORT
19 LOOMBAH STREET
 *INTERNAL FLOOR AREA APPROX 219m²

0 1 2 3 4 5
 SCALE (METRES)



*PLANS SHOWN ONLY INDICATIVE OF LAYOUT. DIMENSIONS ARE APPROXIMATE.

Floor plan supplied by V-Mark Design Pty Ltd. This floor plan is provided for indicative purposes only. Measurements are approximate and not to scale. The vendor, agency and supplier will accept no liability for its accuracy. Interested parties are advised to make their own independent enquiries.