



## 5 Coral Close Avalon Beach NSW

5 3 2

escape to a sublime holiday atmosphere every day of the year with this stunning home, reminiscent of a luxury coastal estate yet overflowing with space and abundant flexibility. immersed in an ambience of absolute seclusion and privacy, it's completely surrounded by vibrant lawns and park-like landscaped gardens - a secret retreat hidden away at the end of a cul-de-sac. embracing up-to-the-minute designer luxury, chic neutral tones and a timeless sense of coastal elegance, its idyllic setting is just moments to local shops, Careel Headland Reserve, Careel Bay and magnificent North Avalon and Whale Beaches.

drenched in streaming natural light and set beneath soaring ceilings, the centrepiece of this gorgeous residence is the L-shaped open plan lounge and dining space. wrapped in French doors and windows, it features a grand sandstone feature wall and a seamless flow to the paved terrace and

**View :** <https://www.blakeproperty.com.au/sale/nsw/north-ern-beaches/avalon-beach/residential/house/5745615>



**Andrew Blake**  
02 9973 4444

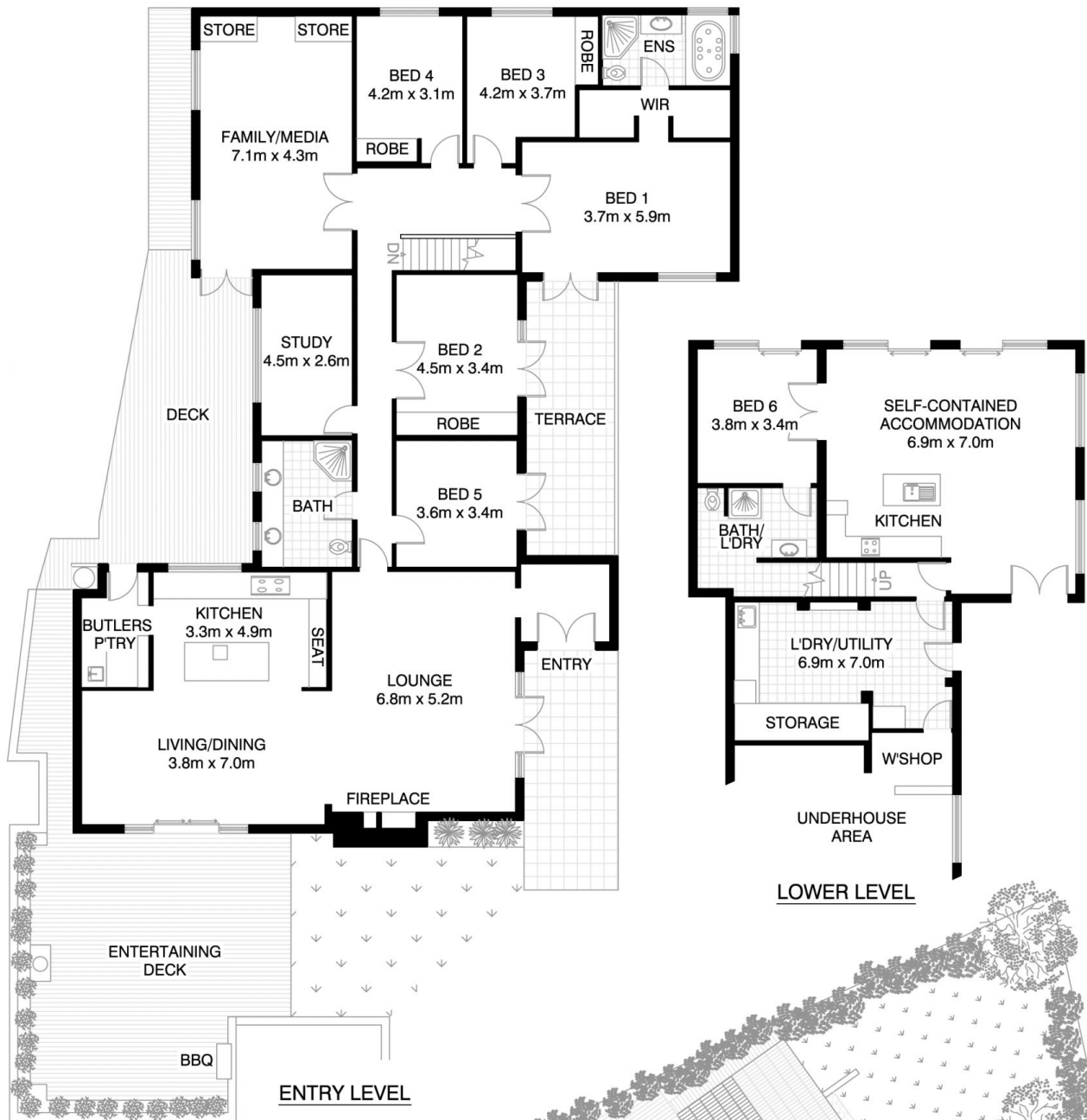

**SITE PLAN**



## WHALE BEACH 5 CORAL CLOSE

\*INTERNAL FLOOR AREA APPROX 357m<sup>2</sup>

0 1 2 3 4 5  
SCALE (METRES)



\*PLANS SHOWN ONLY INDICATIVE OF LAYOUT. DIMENSIONS ARE APPROXIMATE.

Floor plan supplied by V-Mark Design Pty Ltd. This floor plan is provided for indicative purposes only. Measurements are approximate and not to scale. The vendor, agency and supplier will accept no liability for its accuracy. Interested parties are advised to make their own independent enquiries.